

VINSON CHAIR

ASSEMBLY INSTRUCTIONS

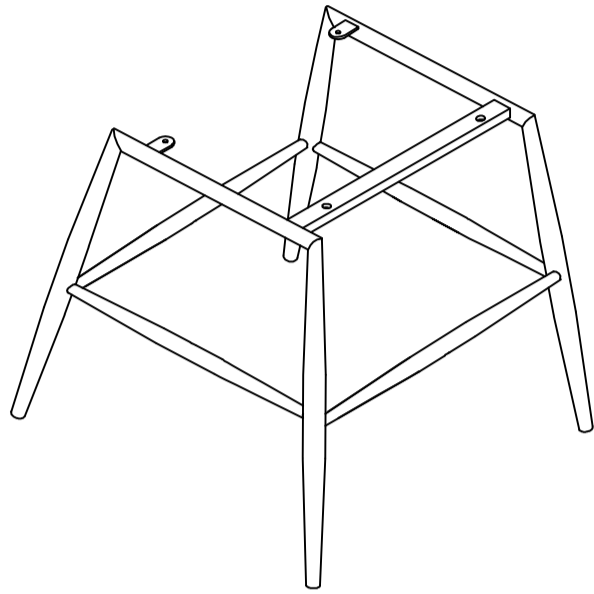

A. Chair Base 1PC



B. Seat Cushion 1PC

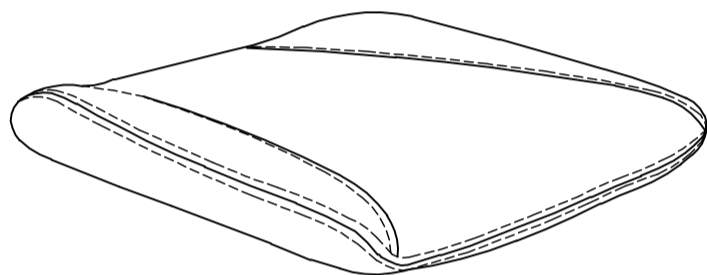

C. Back Cushion 1PC

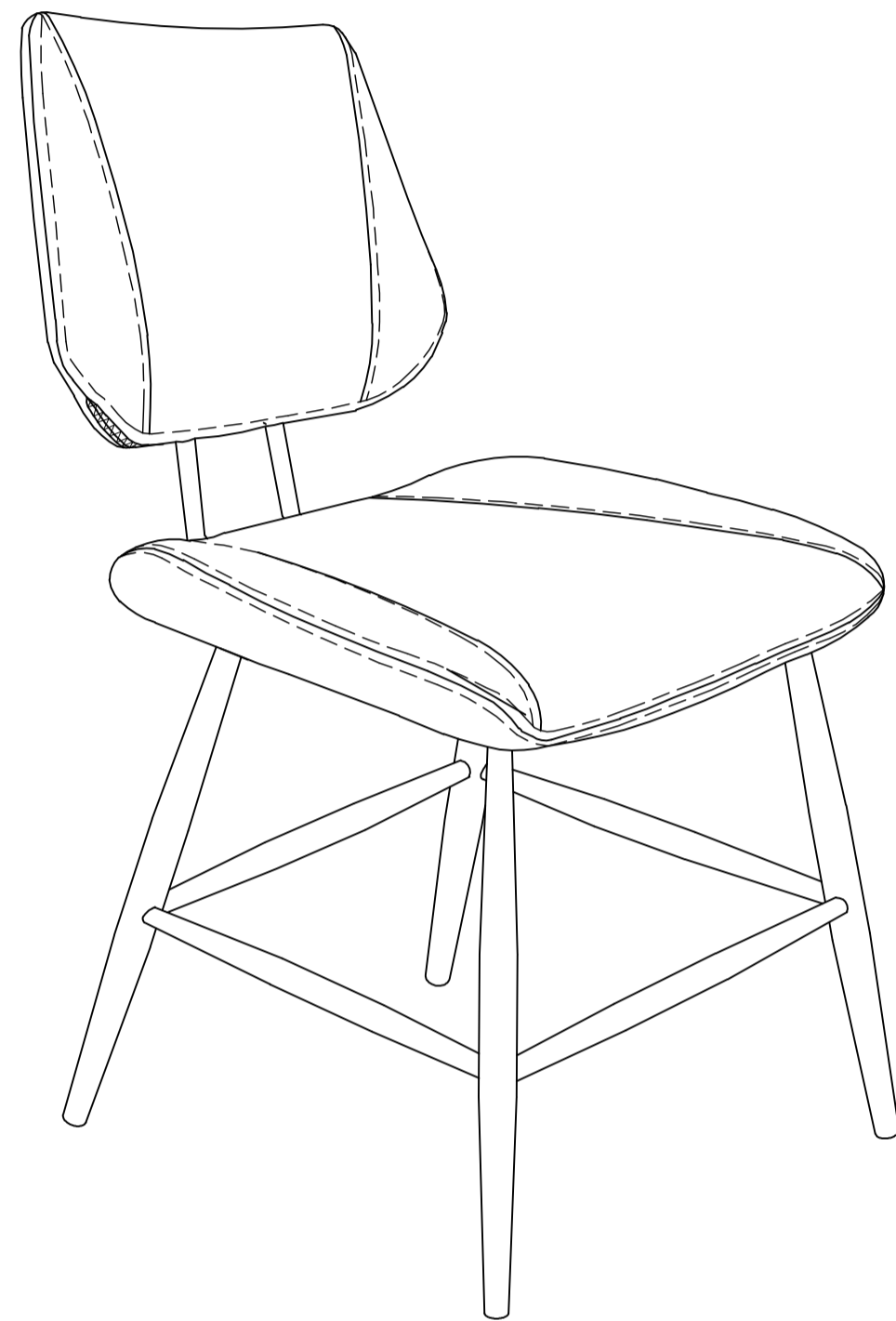
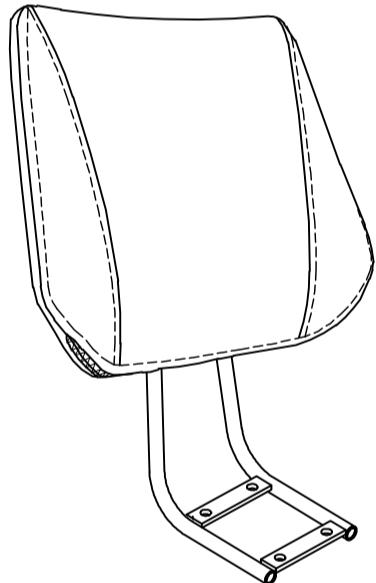

Hardware Packed in Box

1	Allen Bolt (M6X20)	6 PCS	2	Allen Bolt (M6X25)	2 PCS	3	Lock Washer (M6)	8 PCS	4	Flat Washer (M6)	8 PCS	5	Allen Key (M6)	1 PC

STEP 1:

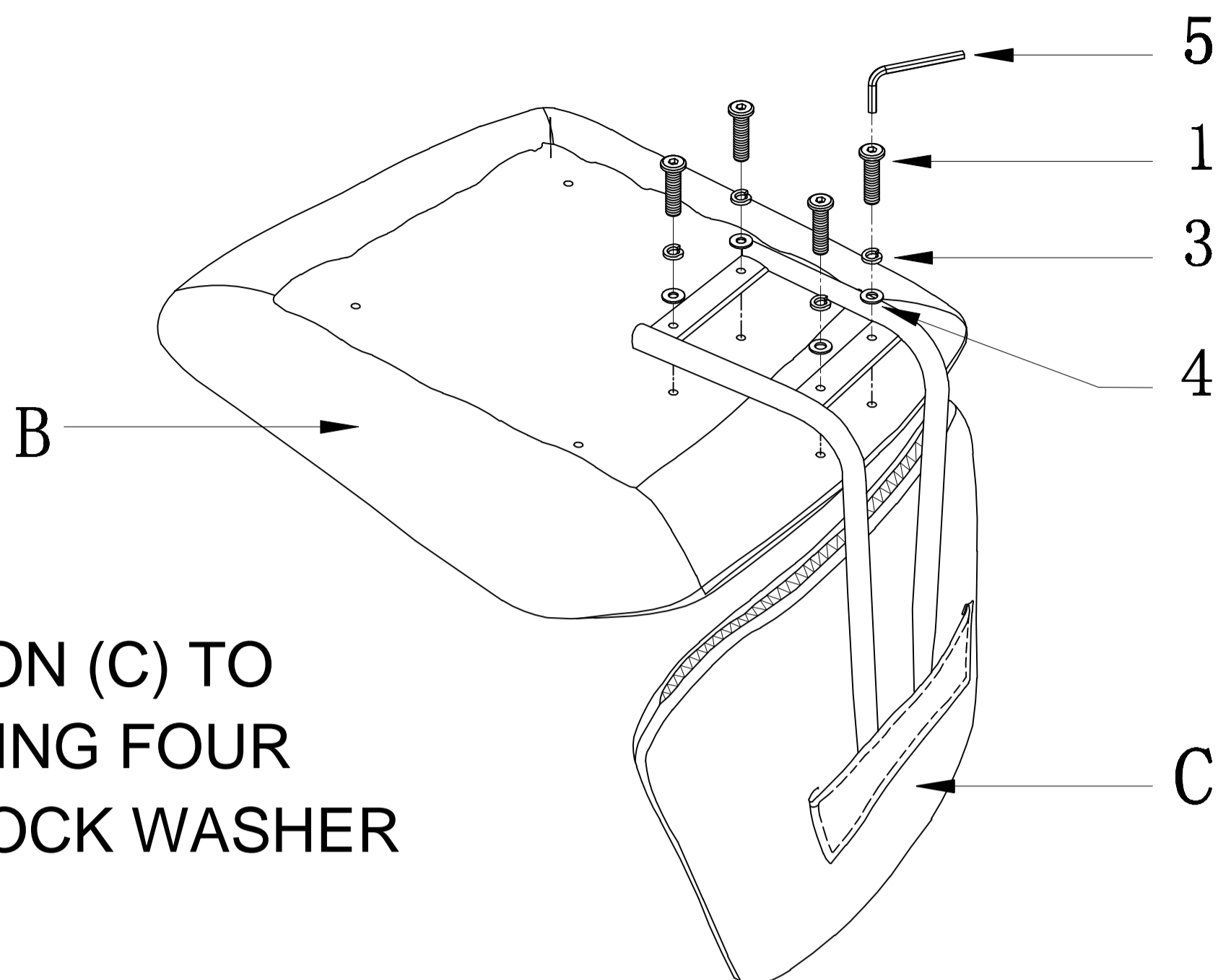

ATTACH THE BACK CUSHION (C) TO THE SEAT CUSHION (B) USING FOUR M6X20 ALLEN BOLTS (1), LOCK WASHER (3) AND FLAT WASHER (4).
TIGHTEN COMPLETELY WITH THE ALLEN KEY.

STEP 2:

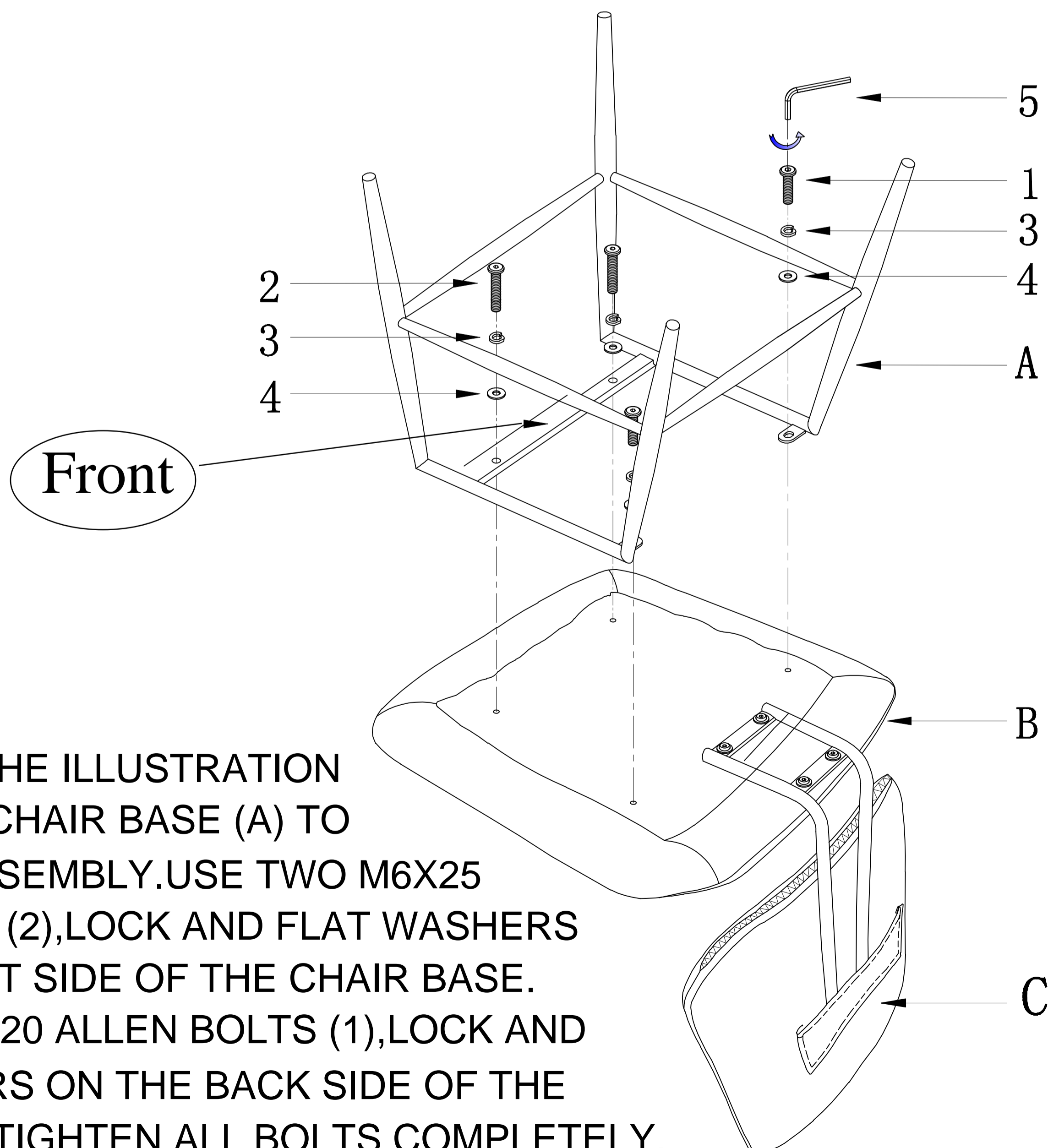

FOLLOWING THE ILLUSTRATION ATTACH THE CHAIR BASE (A) TO THE SEAT ASSEMBLY. USE TWO M6X25 ALLEN BOLTS (2), LOCK AND FLAT WASHERS ON THE FRONT SIDE OF THE CHAIR BASE. USE TWO M6X20 ALLEN BOLTS (1), LOCK AND FLAT WASHERS ON THE BACK SIDE OF THE CHAIR BASE. TIGHTEN ALL BOLTS COMPLETELY.