

1

Remove the nut from screw on the bottom of chair before install the base

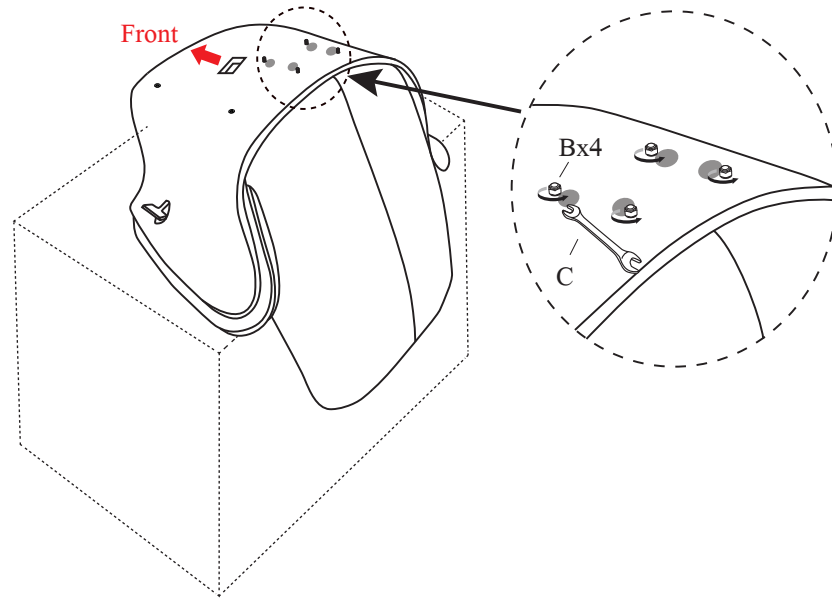

A	KF.A1200-Chair-A Base	x 1
B	KF.A1200-Chair-B Nut	x 4
C	KF.A1200-Chair-C Spanner	x 1
D	KF.A1200-Chair-D Headrest	x 1

326089
SOLANA WHEAT RECLINING
SWIVEL CHAIR W/ADJUSTABLE
HEADREST



2

Do not fully tighten the bolts until all bolts are installed

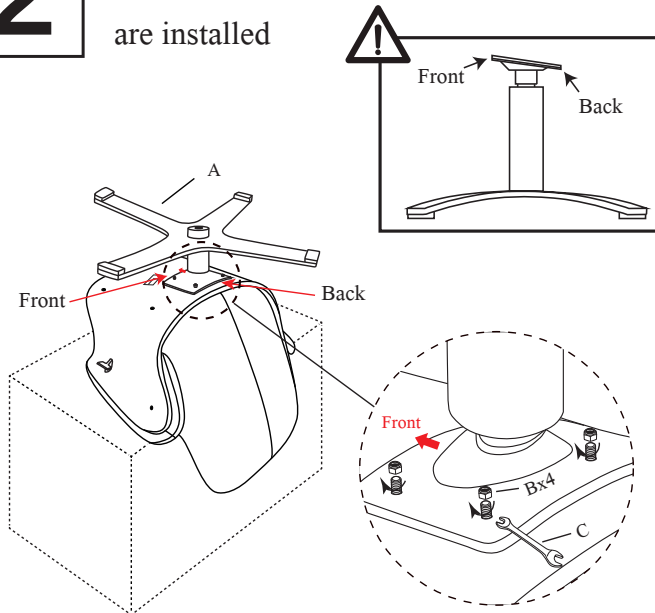

3

Insert the headrest

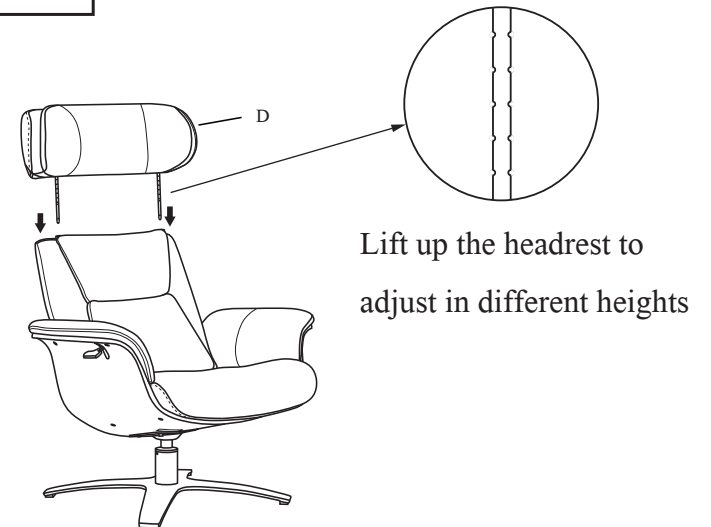

Living Spaces Information	
LS SKU:	326089
LS Product Name:	SOLANA WHEAT RECLINING SWIVEL CHAIR W/ADJUSTABLE HEADREST
Vendor Model #:	KF.A1200
Vendor Collection:	CHAIR

CODE	PART #	DESCRIPTION	QUANTITY	NOTES
1	KF.A1200-A	Base	1	
2	KF.A1200-B	Nut	4	Locknuts should be taken from the bottom of Chair Body
3	KF.A1200-C	Spanner	1	
4	KF.A1200-D	Headrest	1	

NOTICE:

Adjustment Method



1. Leaning back, the backrest will automatically open. Standing up, the backrest can not automatically close.

1. Tools: vice, wrench
2. Method :
 1). Loosen the adjustment nut.
 2). Shorten (clockwise) the adjustment distance.
 3). Fix the adjustment nut.

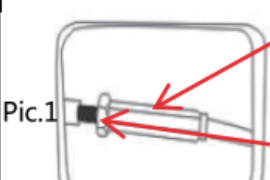

Pic.1

Fix the connection with a vice

Loosen the adjustment nut with a spanner

2. Backrest can not open.

1. Tools: vice, wrench
2. Method :
 1). Loosen the adjustment nut.
 2). Lengthen (anticlockwise) the adjustment distance.
 3). Fix the adjustment nut.

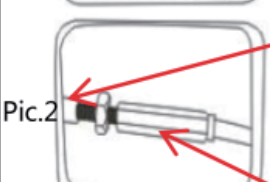

Pic.2

Clamp the hardware casing with a vice

Turn the connection clockwise or anticlockwise with a spanner

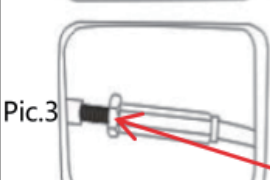

Pic.3

Lock the adjustment nut with a spanner (Pic.1)

Normally, shorten or lengthen 2-3mm, adjusted as appropriate.

Push Forward



Adjustment Method of Headrest

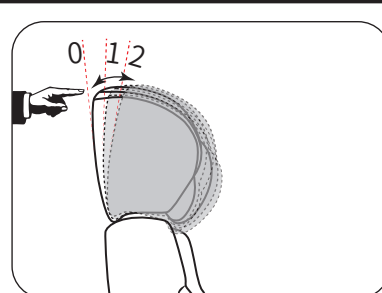

● Push the headrest forward slightly, and you can customize 3 positions for your headrest (including the first position-0).

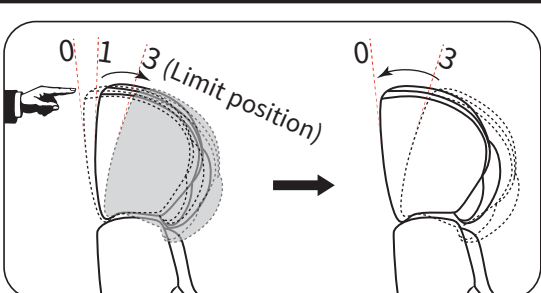

● Reset: To reset the headrest back to its original position you simply push all the way forward and then all the way back