



LIVING SPACES

1805 STETSON POWER SOFA GROUP

USER MANUAL

Troubleshooting Guide

This guide is to help with a non-functioning power recliner

Components:

- **Switch** – mounted on the side of furniture and controls all motors and functions (reclining, power headrest, lumbar, etc.) via a direct connection with motors.
- **LCD touch pad** – mounted on top of console of love seat, controls all motors and functions(reclining, power headrest, lumbar and light cup holder) via a direct connection with motorrs.
- **AC wall plug** – connects the power transformer to the power outlet.
- **DC cord** – connects the power transformer to the DC socket (mounted on the rear bottom of LAF arm stump).
- **DC socket** – receives power from DC cord then transfer to motors.
- **Power Transformer** – A box-shaped unit to transfer 110V AC power to 25V DC power to supply for the furniture.
- **Control box** – connecting the switch to the seat motor and Reading light.
- **Cup holder** – mounted on top of console of love seat.
- **Seat / Headrest/ Lumbar Motor** – motors mounted on mechanism to drive movement on seat/headrest/lumbar via switch control.
- **Mechanism** – the motion mechanical frame unit within the piece of furniture.
- **USB Ports**- located on side switches (for sofa & love seat & chair) for charging USB-supported devices.
- **Power Strip** – located on the drop-down table and supplies 110V AC power.
- **Reading light** – located inside the headrest of center seat, flip up the headrest to reveal.

Quick Trouble-Shoot for Motors Malfunctioning:

Below are some possible reasons to cause motors to stop working:

1. Loose connection or wires not securely plugged in.
2. Broken side switch
3. Broken DC socket
4. Broken power transformer (especially when ALL motors stops working on one unit)
5. Power cords damaged
6. Motors failure

NOTE: In some cases a button on the switch might be stuck after being pushed, thus continuously activating the motor. This can cause overheating or even damages on the power transformer.

Trouble-Shooting Guide

序号 NO	故障 The fault	诊断 diagnosis	排除 To rule out
1	通电后电源指示灯不亮无输出 Power supply don't light up, and no output	电源损坏 The power supply fail	更换电源 Replace a new power supply
2	电源指示灯闪烁 Power supply light flashing	电源自我保护功能启动信号，电气件和线材出现短路现象 Power self-protection function start signal, parts and wires may be shorted	1、检查电机和手控开关线材表面是否有压伤 Check the surface of actuator/hand controller, whether is crushed 2、电机、开关内部短路，更换部件 Internal shorted in the actuator/hand controller, replace the part.
3	电源指示灯常亮，按手控开关后沙发无动作 The light of power supply is always on, press the hand controller, and the actuator can't work.	1、电机未通电，检查电源插头是否松脱 Actuator isn't powered, check whether the plug is loose.	重新接插好插头 Reconnect the plug..
		2、检查插头后，电机仍不动作，交换电机后可动作 After checking the plug, the actuator still can't work, exchange the actuator is OK.	更换电机 Replace a new actuator.
		3、检查插头后，电机仍不动作，交换手控开关后可动作 After checking the plug, the actuator still can't work, exchange the controller is OK.	更换手控开关 Replace a new hand controller.
4	电机开出后无法收回 The actuator cannot be retracted after it has been removed	1、插头是否松动 Check whether the plug is looses.	重新接插好插头 Reconnect the plug..
		2、电机内部故障 The actuator internal failure.	更换电机 Replace a new actuator.
5	电机运行过程中有噪音 There is noise during actuator moving	1.电机本体噪音 The noise in the actuator.	更换电机 Replace a new actuator
		2,铁架部件之间有干涉 The noise caused by the interference of mechanism.	更换铁架 Replace a new mechanism.
6	USB不能给IPAD充电 USB can't charge the IPAD	手控开关USB输出电流为1A 平板为2A The output current of USB is only 1A, the input of IPAD is 2A	不能给IPAD充电 Can't charge the IPAD
7	USB无输出 USB without output	手控开关内部故障 The hand controller internal failure	更换手控开关 Replace a new hand controller
8	Reading light doesn't light up.	1. Loose connection between reading lights and touch-sensor switch	Check and secure connection between reading light and switch (cable can be found behind the back of center seat)
		2. LED light failed	Replace the LED light

Power Sofa PARTS

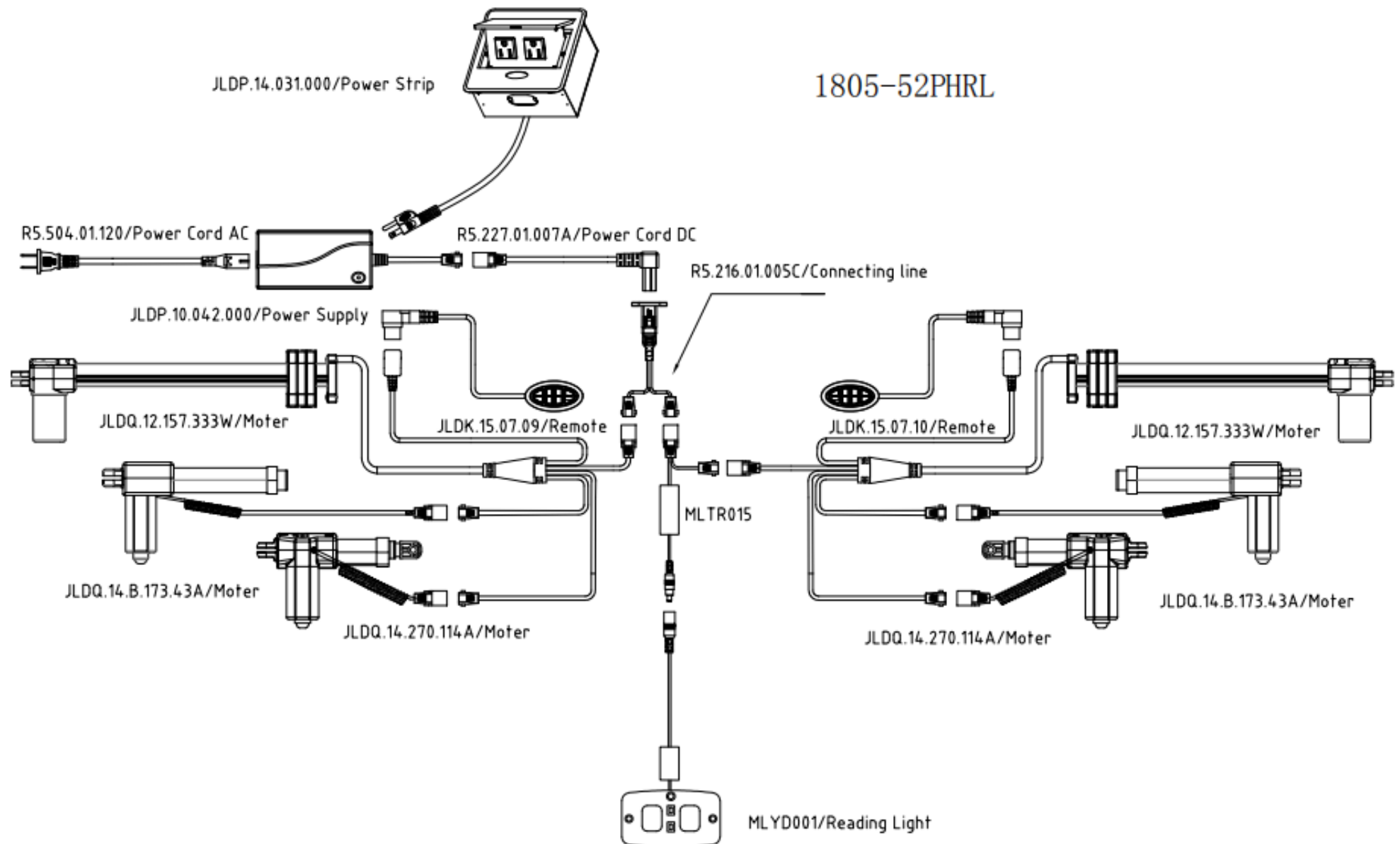

Console Love Seat PARTS

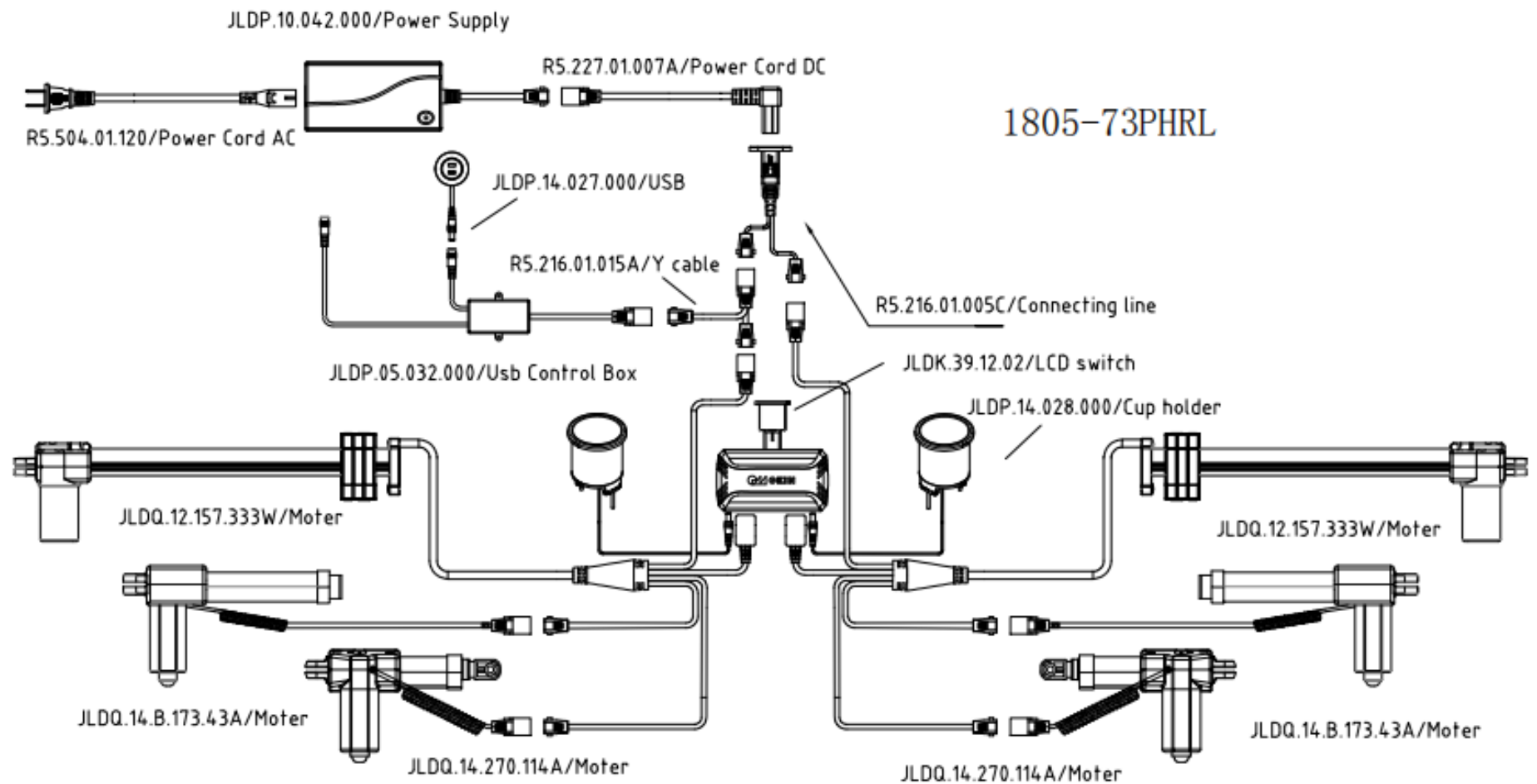

Power Recliner PARTS

1805-85PHRL

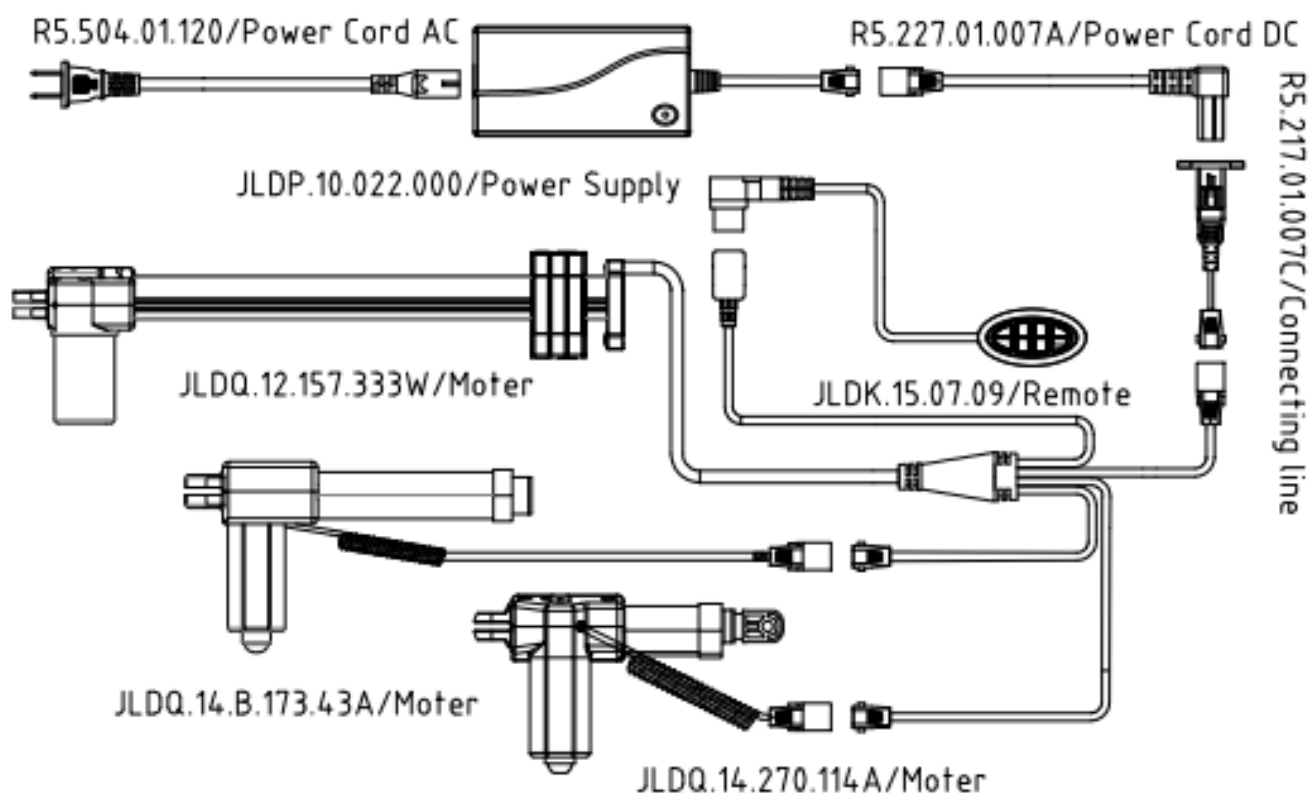

Power Recliner Trouble Shooting

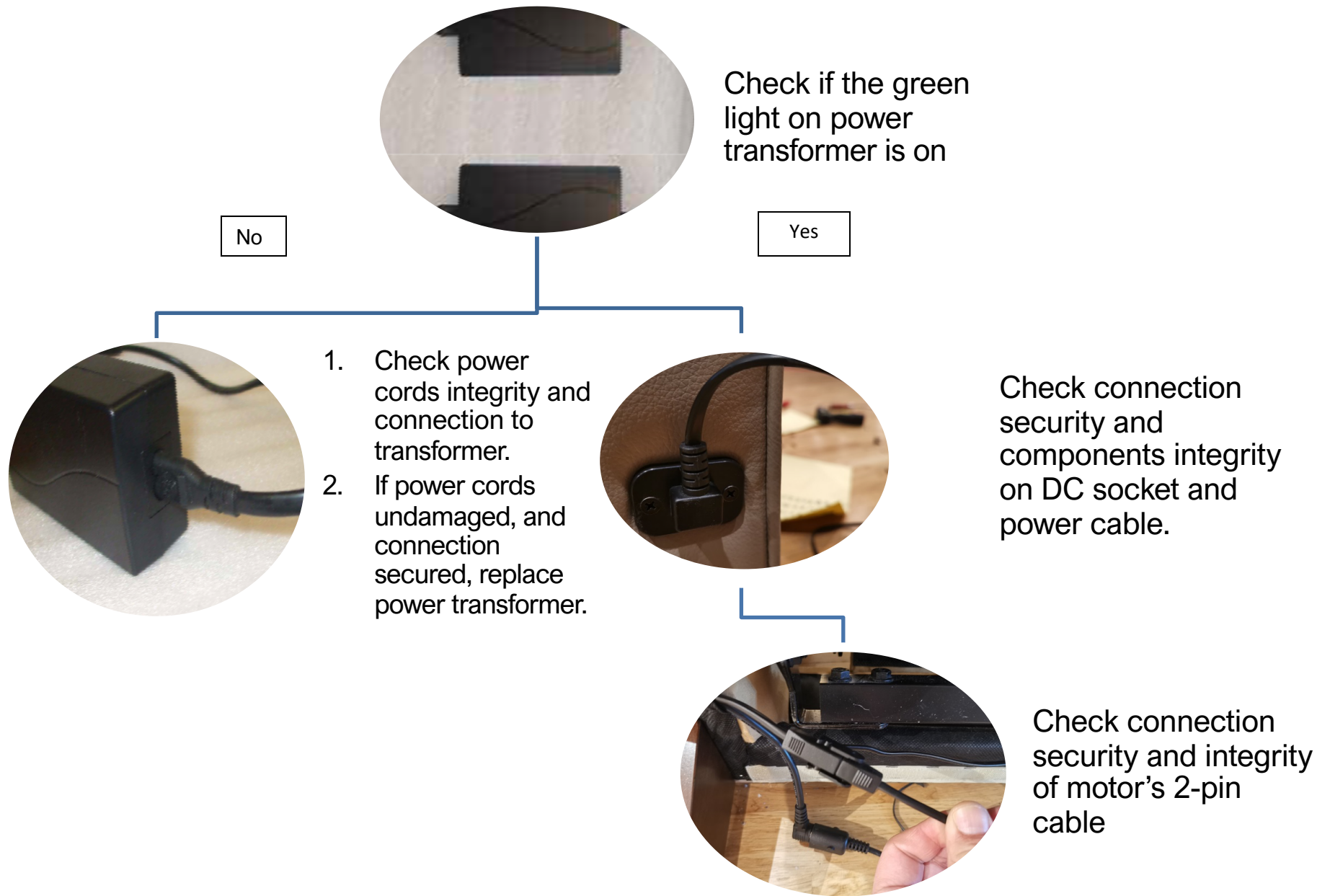

For dual-power recliners, please check connection and integrity of Y-Cable splitter.