

# ASSEMBLY INSTRUCTIONS

ITEM NO : B3150-4  
RIVER CHEST

## BOX OF CHEST

ITEM	DRAWING	DESCRIPTION	QTY
A		CHEST	1
B		LEG (Packed inside drawer)	4
C		TIPPING RESTRAINT (Affix to wall behind Chest) * Located in the Chest 1st Drawer	1

## BOX OF CHEST HARDWARE LIST

ITEM	DRAWING	DESCRIPTION	QTY
1		JCBC BOLT WITH SPRING WASHER AND FLAT WASHER (M6 x 60mm)	8
2		ALLEN KEY (M4)	1



**COMPLETED CHEST ASSEMBLY**

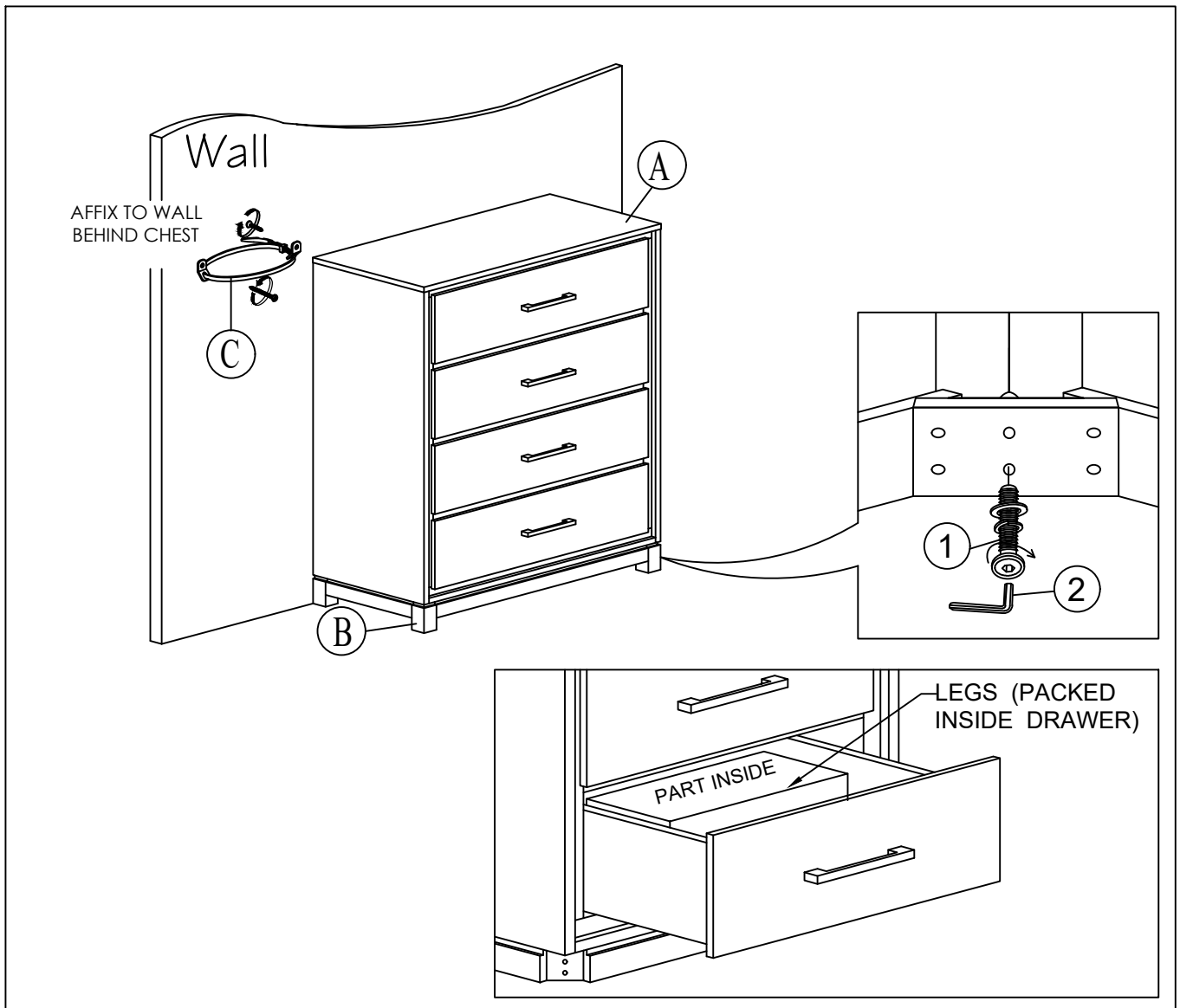
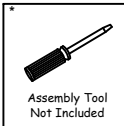

**THE HARDWARE IS LOCATED IN THE PACKING ITEMS  
THE ANTI TIPPING HARDWARE IS LOCATED IN THE CHEST 1ST DRAWER**

NOTE : MUST TIGHTEN SCREWS PERIODICALLY. WITH USE SCREWS MAY BECOME LOOSE.  
CHECK TIGHTNESS OF ALL SCREWS EVERY 6-8 WEEKS.

### CLEANING INSTRUCTION

After assembled, clean & polish the completed parts if necessary with soft cloth and industrial recognized furniture polish



**MADE IN MALAYSIA**